



Setting up the Polycom[®] RealPresence[®] Group 550 System

Main Product Components

主要产品组件



Charge the Battery

为电池充电



Minimum Setup

最简设置



Optional Setup

可选设置

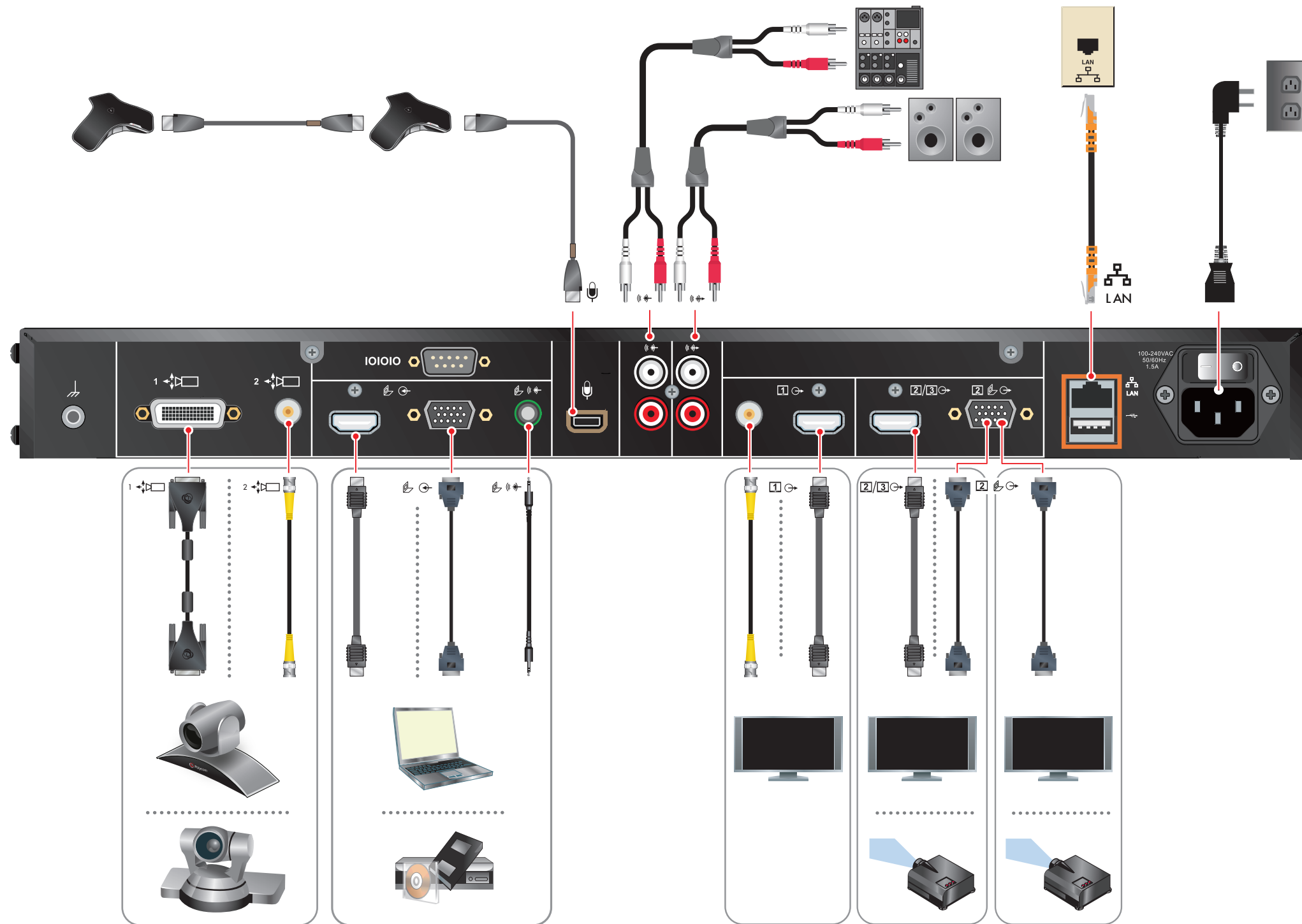

Power on the System

开系统电源



When the system is powered on successfully, the LED on the front panel turns blue
当系统成功启动后，前面板的LED灯变成蓝色

Front Panel

前面板

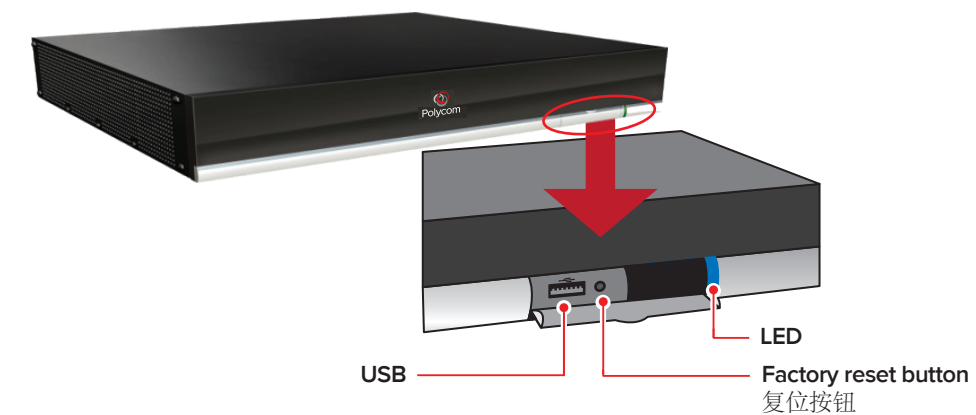

Product Documentation

产品文档

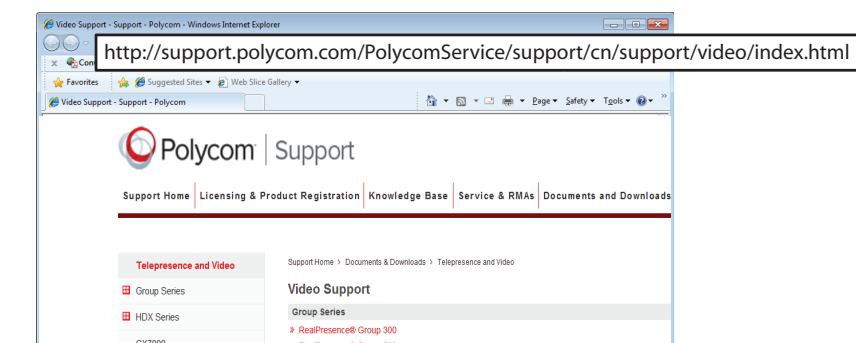

1725-82802-001/B

